

**USE WITH
REACTION ARM 1**

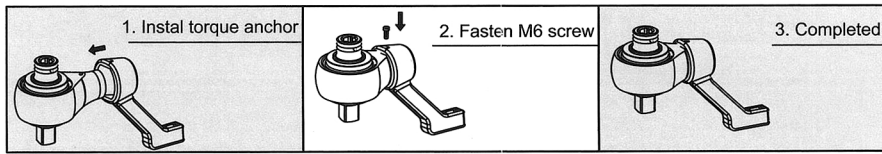

**USE WITH
STANDARD TORQUE
BAR 2**

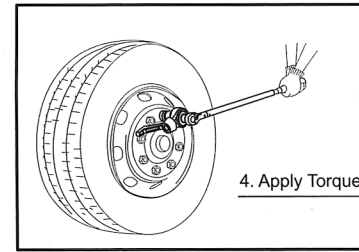
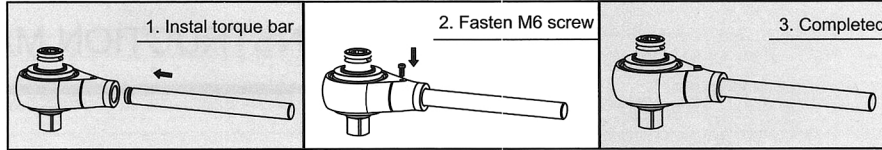

⚠
DON'T USE PNEUMATIC TOOL
TOGETHER WITH THE MULTIPLIER.

SAFETY INSTRUCTIONS

1. Determine the required torque setting of fastener before use to avoid damage of wrench or multiplier.
2. The Reaction Arm must be positioned against a solid object or surface adjacent to the bolt to be tightened or loosened.
3. Be careful to ensure that the reaction Arm (Standard Torque Bar) is only used within the limitation. For special applications or use with deep sockets must be used the standard arm may be extended but only within the limitation show in figure.(below)
4. The rated output torque is the maximum constraint value and we suggest the optimum use range will be under 70%.
If apply to the rated output value, it might cause the product damaged or the service life shortened.

FIGURE

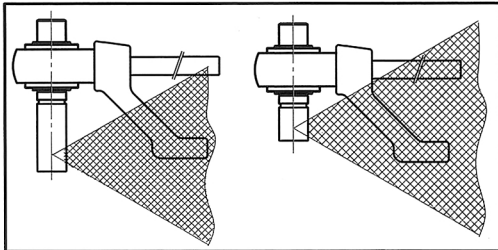

⚠ WARNING

1. Standard square drive extensions must not be used as this may cause serious damage to the Output Square Drive.
2. Do not use impact wrench with torque multiplier.
3. When torque wrench “clicks” or “breaks”, discontinue use immediately.



ALWAYS USE EYE PROTECTION WHILE USING HAND TOOLS



ELECTRICAL SHOCK