

LS-S50MLR 18 mm Cylindrical Laser Sensor

SHIMPO Instruction Manual



LS-S50MLR 18 mm Cylindrical Laser Sensor

- Visible Red Light Source
- Rugged Metal Housing
- NPN or PNP Connection
- Mounting accessories and cable included

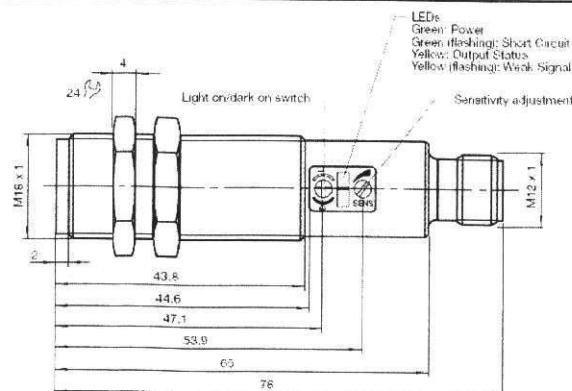

Specifications

Sensing Range	25-400 mm
Sensing Head	Straight
Output	NPN normally Open
	NPN normally Closed
	PNP normally Open
	PNP normally Closed
Load Current	200 mA max
Voltage Drop	$\leq 2.5\text{VDC}$
Short Circuit and Overload Protection	Yes
Reverse Polarity Protection	Yes
Supply Voltage	10-30 VDC
Voltage Ripple	10%
LED Indicators	Yes (2)
Current Consumption	$\leq 30\text{ mA}$
Operating Mode	Light on/ Dark On
Response Time	$\leq 1.0\text{ms}$
Switching Frequency	500 Hz
Standards EN 60947-5-2	
Protection (IEC)	IP67
Light Spot Size	$\sim 0.5\text{mm}$ at range of 170mm
Ambient Light Resistance	$\leq 30,000\text{ Lux}$
Working Temperature	-13 F to 158 F
Storage Temperature	-22 F to 158 F
Housing Material	Nickel-plated Brass
Weight	2.1 oz
Light Source	Visible Red Laser 660 nm
Electrical Connection	Quick Disconnect

Right Angle Mounting Bracket

Dimensions in mm

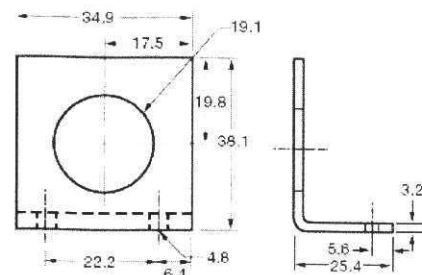

Excess Gain vs. Sensing Range

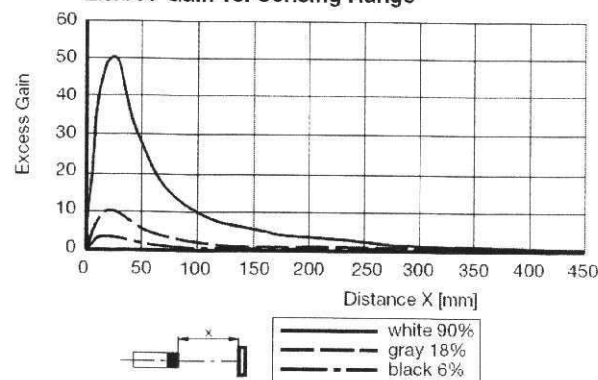

Connection

Black	Signal
Brown	10VDC~30VDC
Blue	0V

Includes

Part Number	Description
CABLE-LS-S50MLR	6.5 Feet of Black cable with quick disconnect connector
TAPE	Reflective Tape
VT18-8 -400	Sensor mounting bracket Right Angle

CAUTION

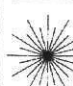
LASER RADIATION — DO NOT STARE INTO BEAM
 660nm LASER LIGHT
 $< 2\text{mW}$ PEAK POWER
 PRODUCT CONFORMS TO 21CFR1040
 CLASS II LASER PRODUCT
 AVOID EXPOSURE - Laser radiation is emitted from this aperture