

Series **STE**

WRENCH EXTENSION TORQUE SENSORS

Reference Guide

GENERAL

Carefully remove the sensor from its packaging and inspect for any damage.

The sensor is shipped ready to use. No assembly is required.

Series STE torque sensors work in conjunction with the BGI force/torque indicator for instantaneous, average, and peak torque measurements. Simply plug the 15-pin connector into the external sensor connector on the indicator.

Please note that all calibration data and menu selections programmed and saved during setup with the BGI are saved within the sensor. While this allows for interchangeability, each sensor must be programmed separately.

In order to extend the life of your unit, avoid repetitive shock and impact loading.

DIMENSIONS AND SPECIFICATIONS in [mm]

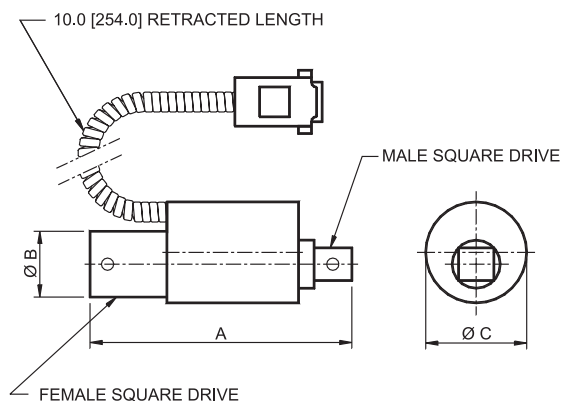

Model	Capacity x Resolution	A	ØB	ØC	Drive Size
STE20	20 x 0.02 lbin, 230 x 0.2 kgFmm, 220 x 0.2 Ncm	1.88 [47.8]	0.56 [14.2]	1.00 [25.4]	1/4"
STE50	50 x 0.05 lbin, 580 x 0.5 kgFmm, 570 x 0.5 Ncm				
STE100	100 x 0.1 lbin, 1150 x 1 kgFmm, 1150 x 1 Ncm				
STE200	200 x 0.2 lbin, 2300 x 2 kgFmm, 2200 x 2 Ncm	3.00 [76.2]	0.73 [18.5]	1.12 [28.6]	3/8"
STE400	400 x 0.5 lbin, 4600 x 5 kgFmm, 4500 x 5 Ncm				
STE1000	1000 x 1 lbin, 11500 x 10 kgFmm, 11000 x 10 Ncm	3.50 [88.9]	0.98 [24.9]	1.25 [31.8]	1/2"
STE5000	5000 x 5 lbin, 55 x 0.05 kgFm, 550 x 0.5 Nm	5.00 [127.0]	1.48 [37.6]	2.0 [50.8]	3/4"

Accuracy: $\pm 0.6\%$ FS + BGI

Operating conditions:

Temperature: 40°F - 110°F [5°C - 45°C]

Humidity: 96% max. (no condensation)

Safe overload % of capacity: 150